

GOTSCHLICH
DREHSPERREN

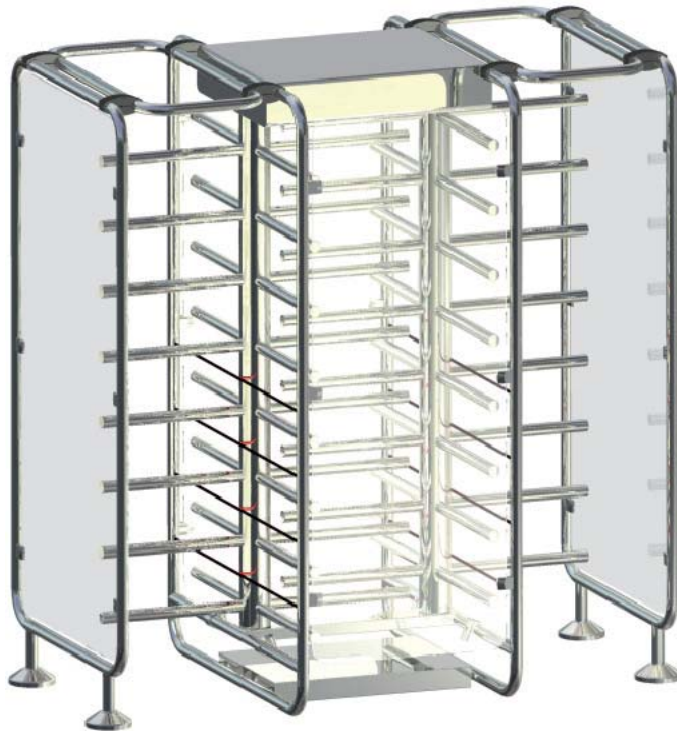

VARIO 2100 D

Representation with optional lane dividers item no. 2V187

Vertical turnstile, full height, 90° separation

Especially well suited for high-traffic, unattended indoor and outdoor entry and exit points in pools and recreation facilities and in architecturally sensitive buildings.

- Small installation size, maximum security
- Silent running
- LOGITURN controls
- Bidirectional operation
- High traffic capacity
- Long service life
- Transparent design complements any architecture
- Saltwater version available
- Integrated control unit
- Maintenance-free mechanism
- Extensive range of accessories

Functional Description:

The motorized, full-height Vario 2100D double vertical turnstile is made entirely of rustproof materials and is especially well suited for use at unmonitored access points in pools and recreation facilities.

The drive and controls are located on top and thus protected from ground moisture.

Vario 2100D is part of a product line that covers the full range of requirements of swimming pools and similar facilities with single and double turnstiles at different heights, motorized swing gates and a wide assortment of accessories.

The Vario 2100D can be used for single or bidirectional operation and is available in saltwater-resistant construction.

Application Areas:

- Pools & Recreation
- Building Access Control
- Supply Facilities
- Events & Stadiums

Technical Characteristics:

Power supply:	24 V DC
Power consumption:	max. 200 VA
Traffic capacity:	3,400 persons/hour
Storage temperature:	-40°C to +50°C
Operating temperature:	+5°C to +50°C
Total/passage width:	1,145 mm / 550 mm
Length:	1,200 mm
Height:	1,300 mm
Weight:	180 kg
Interfaces:	RS485, potential-free contacts, optocoupler inputs, optional RS232
Material:	CrNi steel grade 1.4301 acrylic glass

Models:

6V902: VARIO 2100 D-90 double turnstile

Options:

2100: Saltwater-resistant V4A construction

21683: Base console

21770: Green signal light

6P407: External control console

6P408: External control console

6P930: Power supply 200 VA, 2x12V

2PV12: Touchless sensor start

2PV13: Opto-Sensor Assembly

2P782: Climb-over/crawl-under protection

Other Products:

6V900: VARIO 2100E-90 double turnstile

2V187: VARIO 2100 acrylic lane divider

Various reader stands

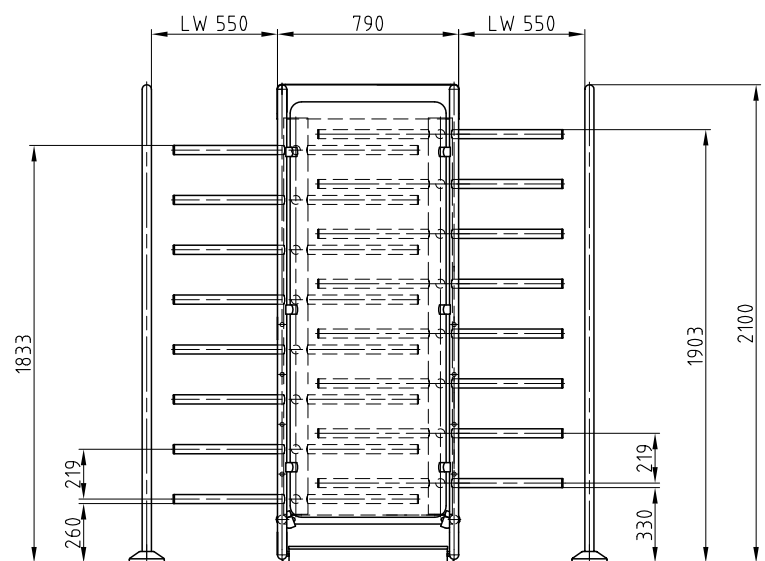

Lane dividers optional